

Technical characteristics



Body type	DOUBLE FLANGE / Vulcanized seat
Characteristics	Concentric and bidirectional
Production range	DN 400-1000
Design standard	EN 593
Face to Face	EN 558-1 Series 14 ISO 5752 Series 14 BS 5155 series 3 Long type
Top flange	ISO 5211
Assembly flanges	PN 10/PN 16/ANSI class 150
Marking	EN 19
Maximum working pressure	16 bar DN 040-150 10 bar DN 200-1000 (16 bar optionally)
Temperature range	-40°C a 210°C depends of material
Hydraulic tests	EN 12266 / ISO 5208 Rate A
Remarks	Pressure equipment directive
Options	ATEX (II 2GD) 2014/34/EU

General description

The FFNV(w) butterfly valve with the vulcanized seat is used when a flanged valve is required for mounting with bolts on each side of the valve. It is very used for buried services, since it does not require almost maintenance by the type of vulcanized ring to the body. Its design allows to be mounted at the end of the line.

Applications

- Naval industry
- Water treatment plants
- Buried valves
- Pipelines water distribution
- Cooling systems



Technical sheets and dimensional drawings

FFNV(w)-001-DT	General dimensions
FFNV(w)-002-DT	Dimensions manual actuator
FFNV(w)-003-DT	Dimensions pneumatic actuator
FFNV(w)-004-DT	Dimensions electrical actuator Bernard
FFNV(w)-005-DT	Dimensions electrical actuator AUMA
FFNV(w)-006-DT	Assembling flanges
FFNV(w)-007-DT	Assembling screws
FFNV(w)-0011-DT	Materials detail DN 400-500
FFNV(w)-0012-DT	Materials detail DN 600-1000



VALVULA DE MARIPOSA "FFNV(W)" / BUTTERFLY VALVE "FFNV(W)"

DIMENSIONES GENERALES / GENERAL DIMENSIONS

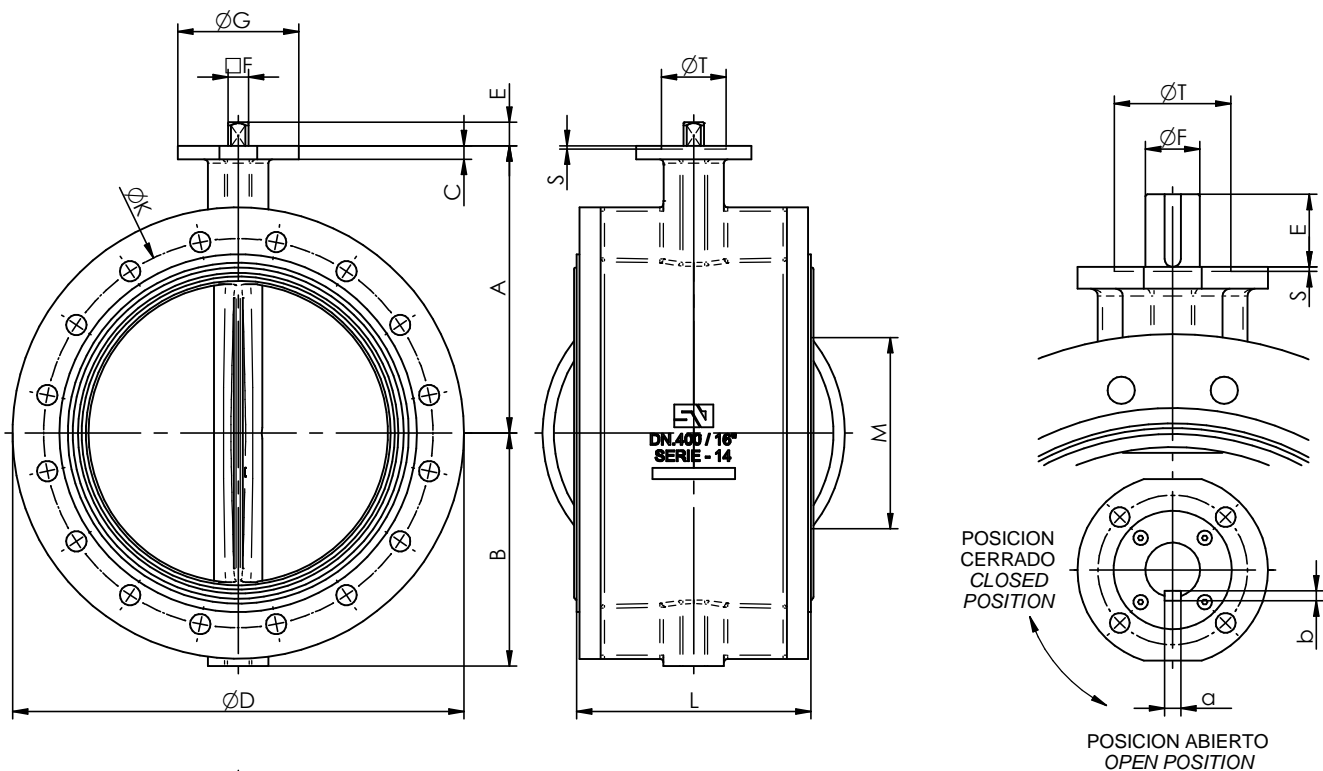

DN 400/500

DN 600/1000

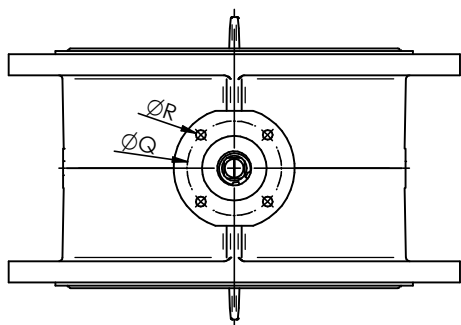

DIMENSIONES GENERALES / GENERAL DIMENSIONS

BRIDA / TOP FLANGE

DN	A	B	C	D	E	F	G	K			L	M	Kg	ISO	Q	R	S	T	a x b	
								PN10	PN16	Cl.150										
400	16"	380	308	18	597	31	27	160	515	525	539.7	310	253	132	F-12	125	4x14	4	85	
450	18"	381	340	20	640	38	36	190	565	585	577.8	330	304	171	F-14	140	4x18	4	100	
500	20"	433	380	22	715	38	36	210	620	650	635.0	350	349	225	F-14	140	4x18	4	100	
600	24"	494	440	24	840	80	60	210	725	770	749.3	390	443	346	F-16	165	4x22	5	130	18x11
700	28"	560	485	25	927	106	65	300	840	840	863.5	430	527	453	F-25	254	8x18	5	200	18x11
750	30"	590	530	25	995	106	80	300	900	900	914.4	470	559	545	F-25	254	8x18	5	200	22x14
800	32"	630	565	29	1060	106	80	300	950	950	978	470	630	613	F-25	254	8x18	5	200	22x14
900	36"	695	610	32	1170	110	80	350	1050	1050	1086	510	729	808	F-25	254	8x18	5	200	22x14
1000	40"	770	675	32	1290	110	80	350	1160	1170	1200	550	823	1007	F-25	254	8x18	5	200	22x14

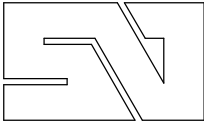

VALVULA DE MARIPOSA "FFNV(W)" / BUTTERFLY VALVE "FFNV(W)" ACTUADOR MANUAL / MANUAL ACTUATOR

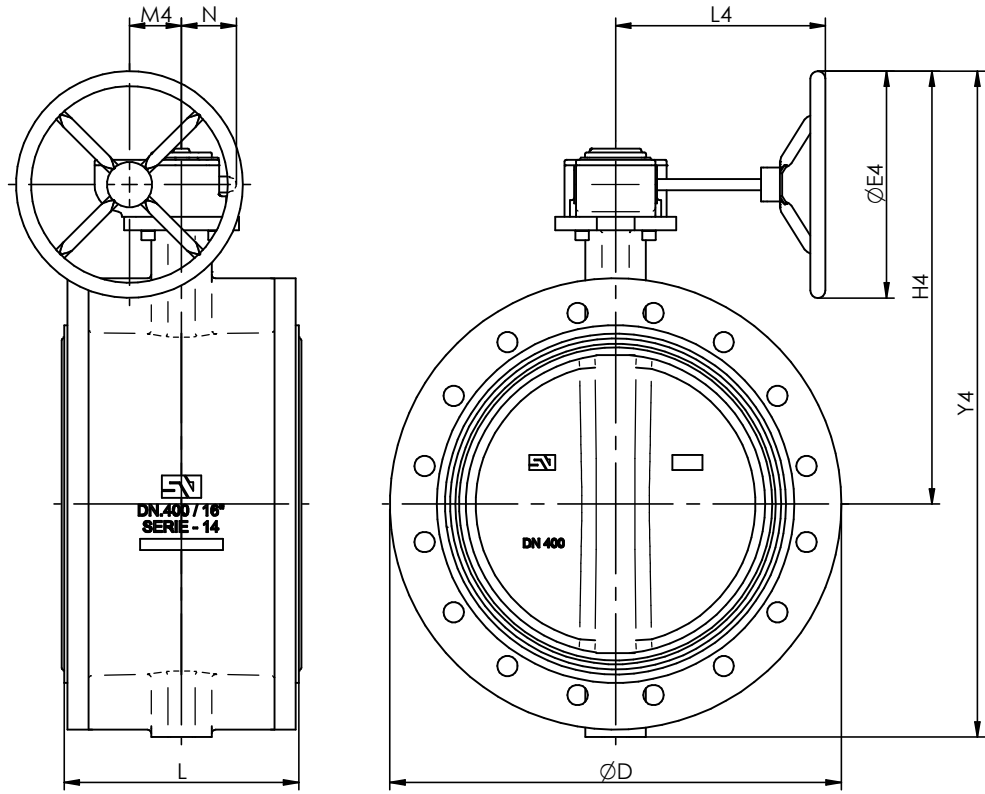

DN	D	L	P.N. Bar	MDV								
				REF	E4	H4	Y4	L4	M4	N	Kg	
400	16"	597	310	10-16	2A/Q-800	300	572	880	277	68.8	72.5	141
450	18"	640	330	10-16	3/Q-2000	400	630	970	321	96.5	91.5	190
500	20"	715	350	10-16	3/Q-2000	400	682	1062	321	96.5	91.5	244
600	24"	840	390	10-16	4/Q-4000	500	798	1239	408	138	140	381
700	28"	927	430	10	4/Q-4000	500	864	1350	408	138	140	488
				16	5/Q-6500	600	914	1400	456	138	140	491
750	30"	995	470	10-16	5/Q-6500	600	944	1474	456	138	140	587
800	32"	1060	470	10	5/Q-6500	600	984	1550	456	138	140	655
				16	6/Q-12000	700	1044	1608	510	180	156	669
900	36"	1170	510	10-16	6/Q-12000	700	1108	1718	510	180	156	871
1000	40"	1290	545	10-16	7/Q-16000	700	1184	1858	579	180	156	1075

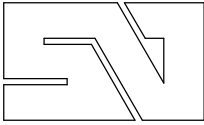

VALVULA DE MARIPOSA "FFNV(W)" / BUTTERFLY VALVE "FFNV(W)" BRIDAS DE MONTAJE / ASSEMBLY FLANGES

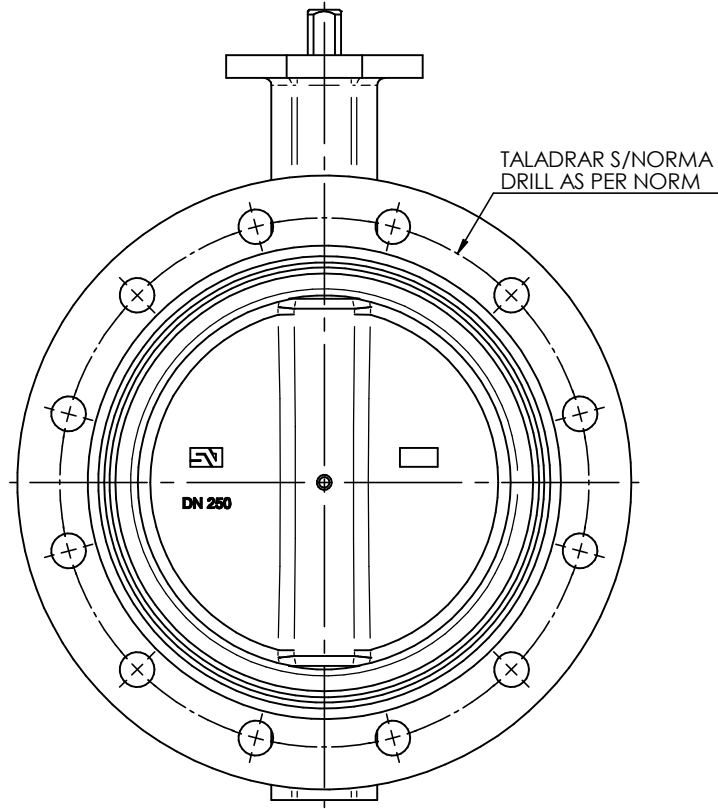

X ESTANDAR / STANDARD
O BAJO DEMANDA / ON REQUEST
-- NO POSIBLE / NOT POSSIBLE

DN		PN.6	PN.10	PN.16	PN.20	ANSI 150 Lbs	AWWA C207	ASME B16.47a-150	ASME B16.47a-300	ASME B16.47b-150	ASME B16.47b-300	BS, D	BS, E	JIS 5k	JIS 10k	JIS 16k	AS 2129 E
400	16"	X	X	X	X	X	X					X	X	--	X	X	X
450	18"	X	X	X	X	X	X					X	X	X	X	X	X
500	20"	X	X	X	X	X	X					X	X	X	X	X	X
600	24"	X	X	X	X	X	X					X	X	X	X	X	X
700	28"	X	X	X	X	X	X	X	--	X	X	X	X	X	X	X	X
750	30"	X	X	X		X	X	X	--	--	X	X	X	X	X	X	X
800	32"	X	X	X		X	X	X	--	--	X	X	X	X	X	X	X
900	36"	X	X	X		X	X	X	--	--	X	X	X	X	X	X	X
1000	40"	X	X	X		X	X	X	--	--	X			X	X	X	X



VALVULA DE MARIPOSA "FFNV(W)" / BUTTERFLY VALVE "FFNV(W)"

TORNILLERIA DE MONTAJE / ASSEMBLYING SCREWING

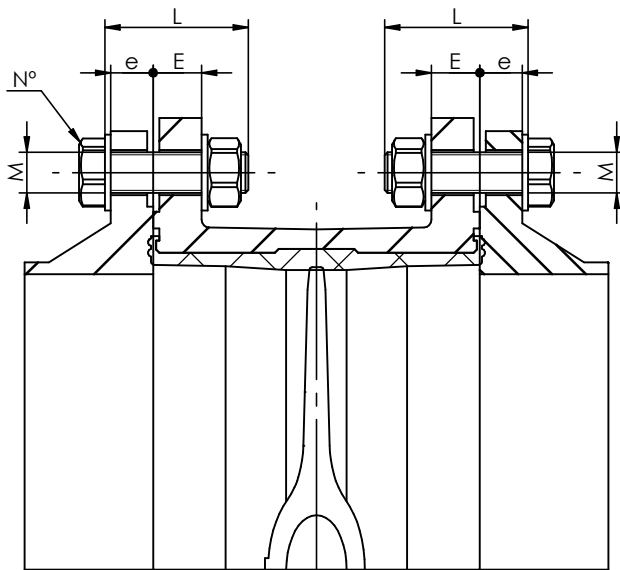

CORTE A-A
TORNILLO / SCREW

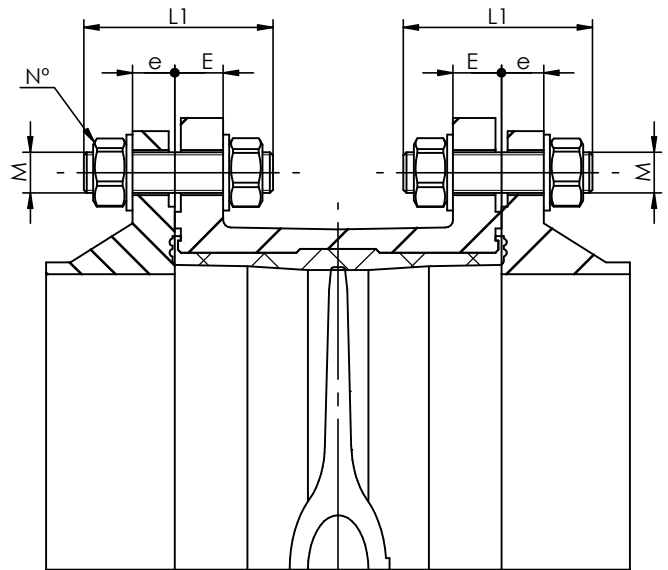

CORTE B-B
VARILLA / ROD

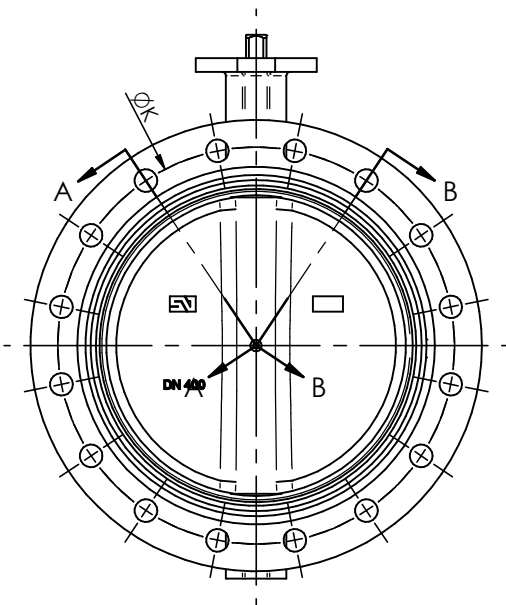

DN	E	PN.10							PN.16					ANSI 150 Lbs / PN.20							
		K	e	M	L	L1	Nº	K	e	M	L	L1	Nº	K	e	M	L	L1	Nº		
400	16"	32	515	26	M24	90	115	32	525	32	M27	100	130	32	539.7	36.5	1"	M27	105	135	32
450	18"	34	565	26	M24	95	120	40	585	32	M27	105	130	40	577.8	39.7	1.1/8"	M30	115	145	32
500	20"	36	620	28	M24	100	125	40	650	34	M30	110	140	40	635.0	46.0	1.1/8"	M30	125	150	40
600	24"	41	725	28	M27	105	135	40	770	36	M33	120	155	40	749.3	47.6	1.1/4"	M33	130	165	40
700	28"	44	840	30	M27	110	140	48	840	36	M33	125	155	48	863.5	52.5	1.1/4"	M33	140	175	56
750	30"	48	900	32	M30	120	150	48	900	38	M33	130	165	48	914.4	54.0	1.1/4"	M33	145	180	56
800	32"	48	950	32	M30	120	150	48	950	38	M36	135	170	48	978	57.0	1.1/2"	M39	155	195	56
900	36"	51	1050	34	M30	125	160	56	1050	40	M36	140	175	56	1086	60.0	1.1/2"	M39	165	200	64
1000	40"	55	1160	34	M33	135	165	56	1170	42	M39	150	190	56	1200	63.5	1.1/2"	M39	170	210	72

VALVULA DE MARIPOSA "FFNV(W)" / BUTTERFLY VALVE "FFNV(W)" DESPIECE DE MATERIALES "DN.400/500" / MATERIALS DETAIL

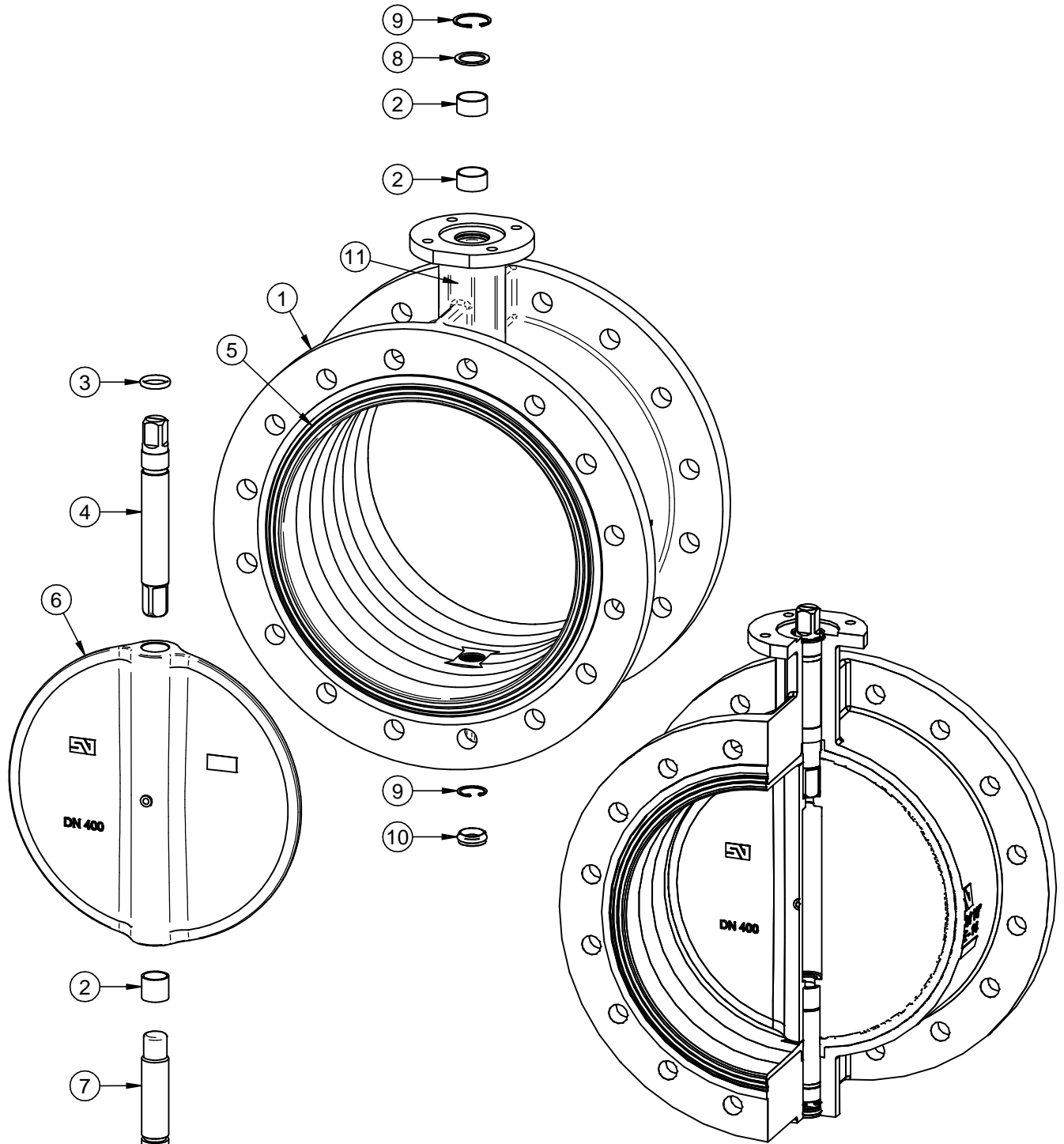

DATOS TECNICOS / TECHNICAL DATA
FABRICACION ESTANDAR / STANDARD PRODUCTION
 - DN.400/500 - 10 Bar
PRUEBA HIDROSTATICA Y DE RESISTENCIA
HYDROSTATIC AND RESISTANCE TEST:
 CON VALVULA ABIERTA / OPEN VALVE:
 - 10 Bar - 15 Kg/cm²
 CON VALVULA CERRADA / CLOSED VALVE:
 - 10 Bar - 11 Kg/cm²

11	PLACA CARACTERISTICAS FEATURES TAG	POLIESTER POLYESTER		1
10	TAPON INFERIOR LOWER PLUG	E.P.D.M.		1
9	ANILLO ELASTICO ZEGI RING BODY	ACERO CINCADO ZINC PLATED STEEL	DIN 472	2
8	ARANDELA RETENCION RETAINING RING	ACERO CINCADO ZINC PLATED STEEL		1
7	EJE INFERIOR LOWER SHAFT	S/ HOJA E-0001 ACC. TO SHEET E-0001		1
6	MARIPOSA DISC	S/ HOJA M-0001 ACC. TO SHEET M-0001		1
5	ANILLO SEAT	S/ HOJA A-0001 ACC. TO SHEET A-0001	VULCANIZADO AL CUERPO VULCANIZED ON BODY	1
4	EJE SUPERIOR UPPER SHAFT	S/ HOJA E-0001 ACC. TO SHEET E-0001		1
3	JUNTA TORICA "O" RING	NITRIL NITRILE		2
2	CASQUILLO ROZAMIENTO BUSHING	ACERO-BZ-PTFE STEEL-BZ-PTFE		3
1	CUERPO DE VALVULA VALVE BODY	S/ HOJA C-0001 ACC. TO SHEET C-0001	RECUB. EPOXY COATING EPOXY	1
POS ITEM	DESIGNACION DESIGNATION	MATERIAL MATERIAL	OBSERVACIONES REMARKS	CANT QUAN

VALVULA DE MARIPOSA "FFNV(W)" / BUTTERFLY VALVE "FFNV(W)" DESPIECE DE MATERIALES "DN.600/1000" / MATERIALS DETAIL

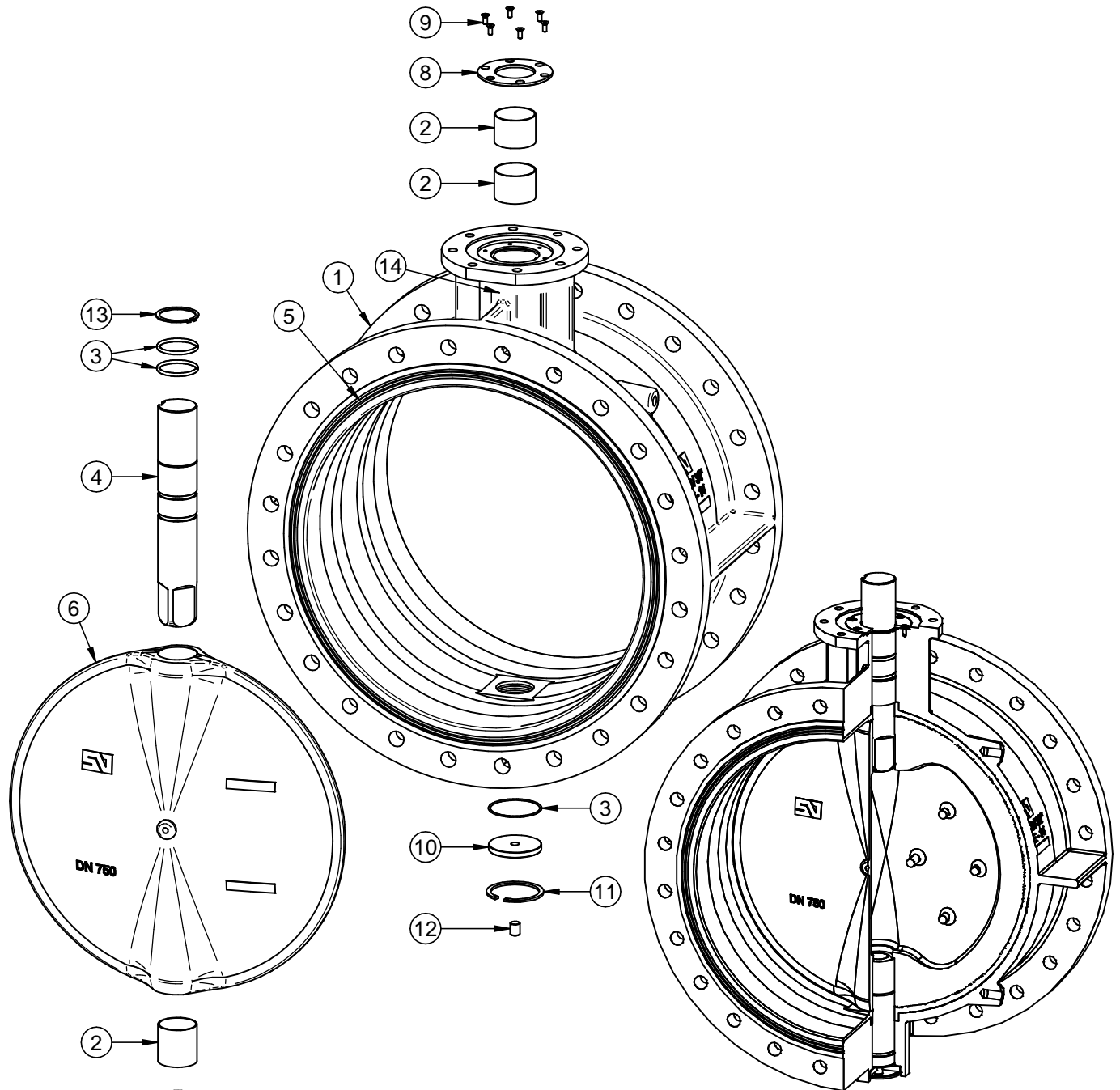

14	PLACA CARACTERISTICAS FEATURES TAG	POLIESTER POLYESTER		1
13	ANILLO ELASTICO EJE RETAINING RING SHAFT	ACERO CINCADO ZINC PLATED STEEL	DIN 471 DN.600/800	1
12	ESPARRAGO SCREW	ACERO CINCADO ZINC PLATED STEEL	DIN 913 DN.750/1100	1
11	ANILLO ELASTICO ZEGI RING BODY	ACERO CINCADO ZINC PLATED STEEL	DIN 472	1
10	TAPA INFERIOR LOWER COVER	ACERO CARBONO CARBON STEEL	RECUB. EPOXY COATING EPOXY	1
9	TORNILLO TAPA SUP BOLT UPPER COVER	ACERO CINCADO ZINC PLATED STEEL	DIN 7991	DN.600: 4 DN.700/1000: 6
8	TAPA SUPERIOR UPPER COVER	ACERO CARBONO CARBON STEEL	RECUB. EPOXY COATING EPOXY	1
7	EJE INFERIOR LOWER SHAFT	S/HOJA E-0001 ACC. TO SHEET E-0001		1
6	MARIPOSA DISC	S/ HOJA M-0001 ACC. TO SHEET M-0001		1
5	ANILLO SEAT	S/ HOJA A-0001 ACC. TO SHEET A-0001	VULCANIZADO AL CUERPO VULCANIZED ON BODY	1
4	EJE SUPERIOR UPPER SHAFT	S/ HOJA E-0001 ACC. TO SHEET E-0001		1
3	JUNTA TORICA "O" RING	NITRILO NITRILE		4
2	CASQUILLO ROZAMIENTO BUSHING	ACERO-BZ-PTFE STEEL-BZ-PTFE		3
1	CUERPO DE VALVULA VALVE BODY	S/ HOJA C-0001 ACC. TO SHEET C-0001	RECUB. EPOXY COATING EPOXY	1
POS ITEM	DESIGNACION DESIGNATION	MATERIAL MATERIAL	OBSERVACIONES REMARKS	CANT QUAN

DATOS TECNICOS / TECHNICAL DATA

FABRICACION ESTANDAR / STANDARD PRODUCTION

- DN.600/1000 - 10 Bar

PRUEBA HIDROSTATICA Y DE RESISTENCIA

HYDROSTATIC AND RESISTANCE TEST:

CON VALVULA ABIERTA / OPEN VALVE:

- 10 Bar - 15 Kg/cm²

CON VALVULA CERRADA / CLOSED VALVE:

- 10 Bar - 11 Kg/cm²